

PROJECT BENCHMARK 01:
THE "O" IN OPEN ON A FIRE HYDRANT
LOCATED 15.5'± WEST OF THE CENTERLINE OF
HARRISON RD.. AND 198'± NORTH OF THE
NORTH RIGHT-OF-WAY LINE OF DELUXE DR.
ELEV.=486.83.

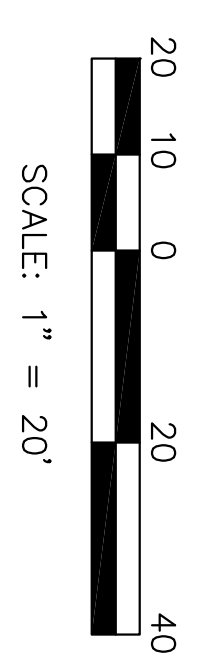

REFERENCE TIE
CONTROL POINT #3
IRON BAR W/ CAP
N 1009667.249
E 825796.128
ELEV 520.69
NOT TO SCALE

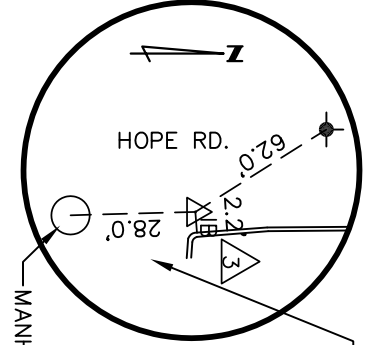

REFERENCE TIE
CONTROL POINT #2
IRON BAR W/ CAP
N 1009623.772
E 826278.578
ELEV 479.45
NOT TO SCALE

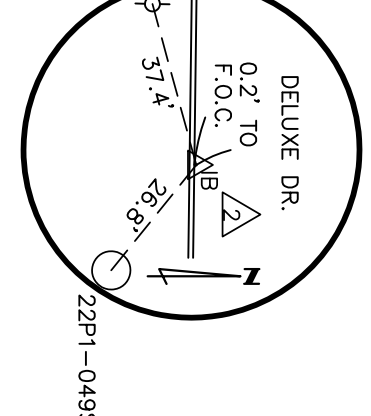

REFERENCE TIE
CONTROL POINT #200
PK NAIL
N 1009866.911
E 826270.644
ELEV 485.36
NOT TO SCALE

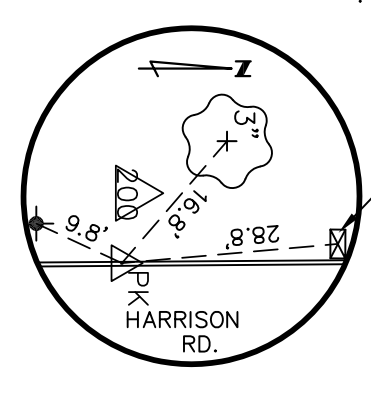

PROJECT BENCHMARK 02:
"SQ" CUT IN THE NORTHWEST CORNER OF THE
NORTH END OF A BRICK ENTRANCE MONUMENT
LOCATED AT THE NORTHWEST INTERSECTION OF
HARRISON RD. AND DELUXE DR.
ELEV.=483.97.

REV.	DATE	DESCRIPTION	BY

#13333 DELUXE DRIVE
(PROJECT ID NUMBER 32)

SABUR, INC.
1751 ASHBY RD. ST. LOUIS, MO 63114
PHONE: (314) 428-1414 FAX: (314) 428-6082
www.sabur-inc.com

Drawn: J.F.B.
Checked: D.R.B.
Date: JUNE, 2011
Sheet No: 2 of 4
Job No: 11-026